

B R O W N ' S W O O D L O C A L P L A Y 2

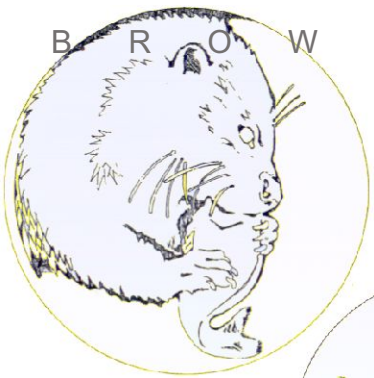

Local stone masons, H.W Mason & sons, were commissioned to produce a series of portland stone corner peices, each with a small animal to one face.

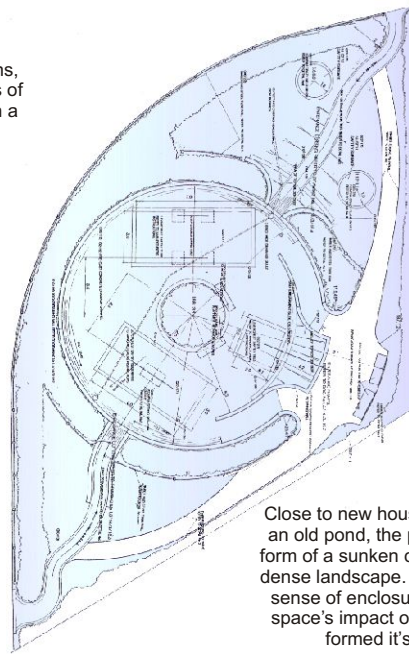

Close to new housing, on the site of an old pond, the play area took the form of a sunken circular basin set in dense landscape. This was to offer a sense of enclosure & to soften the space's impact on the houses that formed it's boundary.

